

Dig a hole Ø 50cm, depth 45cm according to table. Fill with macadam or concrete

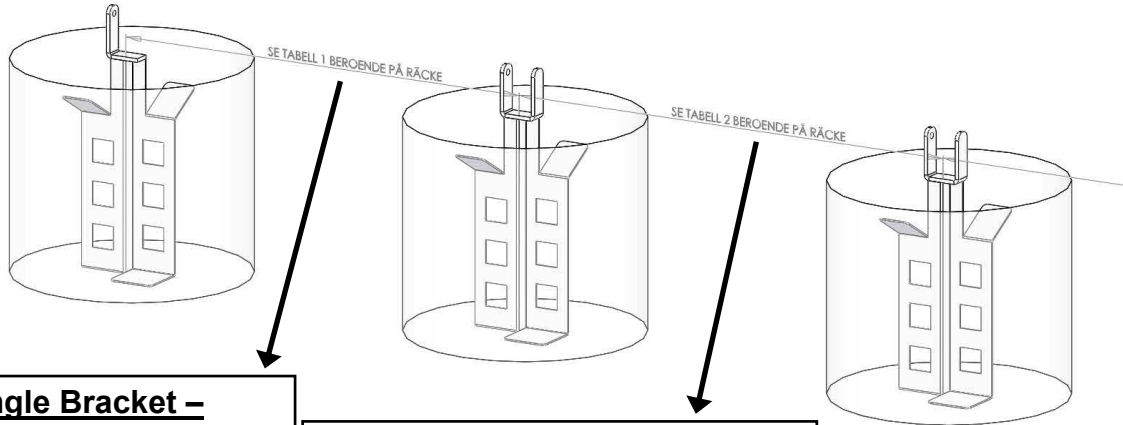
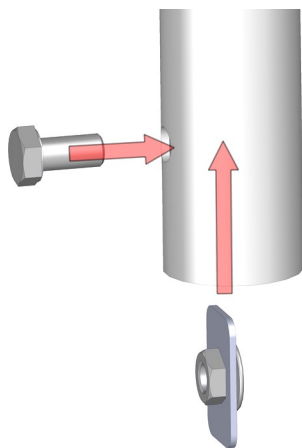

**Table 1 Single Bracket –  
Double Bracket**

UI2042/UB2042	- 1926mm
UI1542/UB1542	- 1426mm
UI1042/UB1042	- 926mm
UI0742/UB0742	- 626mm
UI0542/UB0542	- 426mm
UI0442/UB0442	- 326mm

**Table 2 Double Bracket –  
Double Bracket**

UI2042/UB2042	- 1998mm
UI1542/UB1542	- 1498mm
UI1042/UB1042	- 998mm
UI0742/UB0742	- 698mm
UI0542/UB0542	- 498mm
UI0442/UB0442	- 398mm



Mount the locking device in the railing

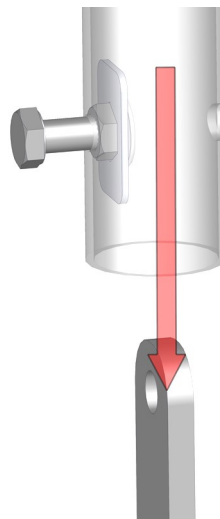

Thread the railing on to the bracket

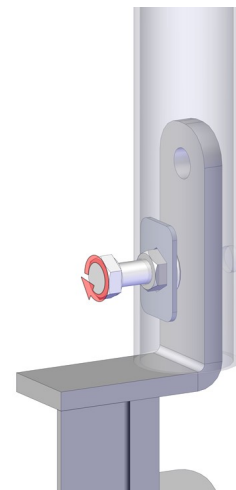

Tighten the locking devices.  
Tighten the securing bolts.

Finally, mount the coupling between the railings.

