

Assemble the standing seam mount around the fold. **NOTE! Don't forget the bolts for the fold support.** Then assemble the fold support on the standing seam mount, in the holes along the plate's centre line.

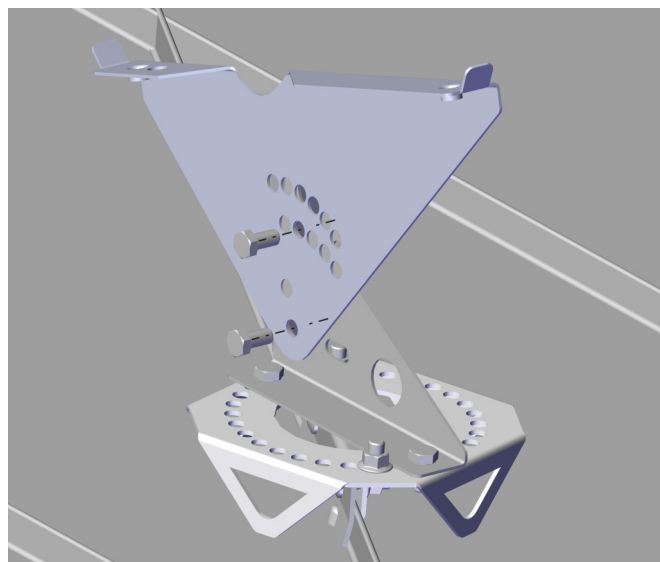

The bracket is mounted in the holes that give the best fit, to keep it parallel with other brackets. ÖB3000 is then attached with the accompanying bolt to get it horizontal. **NOTE! For assembly in the upper holes, the bottom section must be cut off.** Finally, the gangways are mounted.

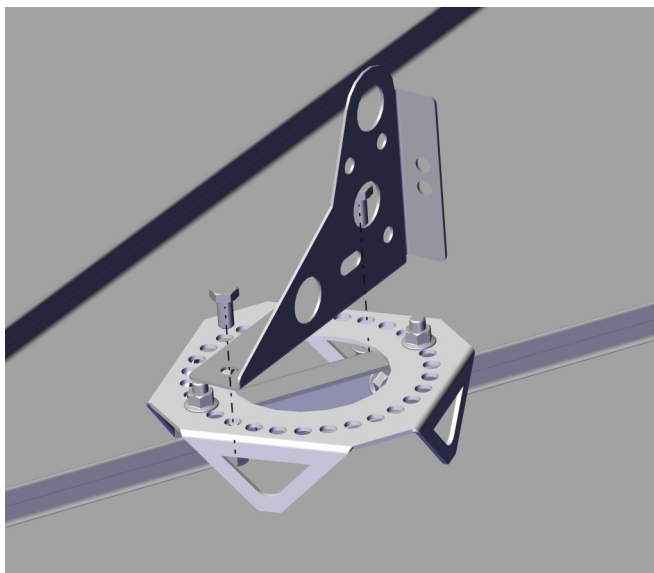